

PROPOSED INTERNAL LAYOUT PLAN OF SONARPUR BRANCH,  
UCO BANK , IN THE NEW PREMISES

block partition–upto full ht.  
partly solid 3’ ht+ 1’ht.glass.  
partly solid 3’ ht.+ 4’ht. glass + 1’ht. solid

low ht. cabinet  
full ht. cabinet

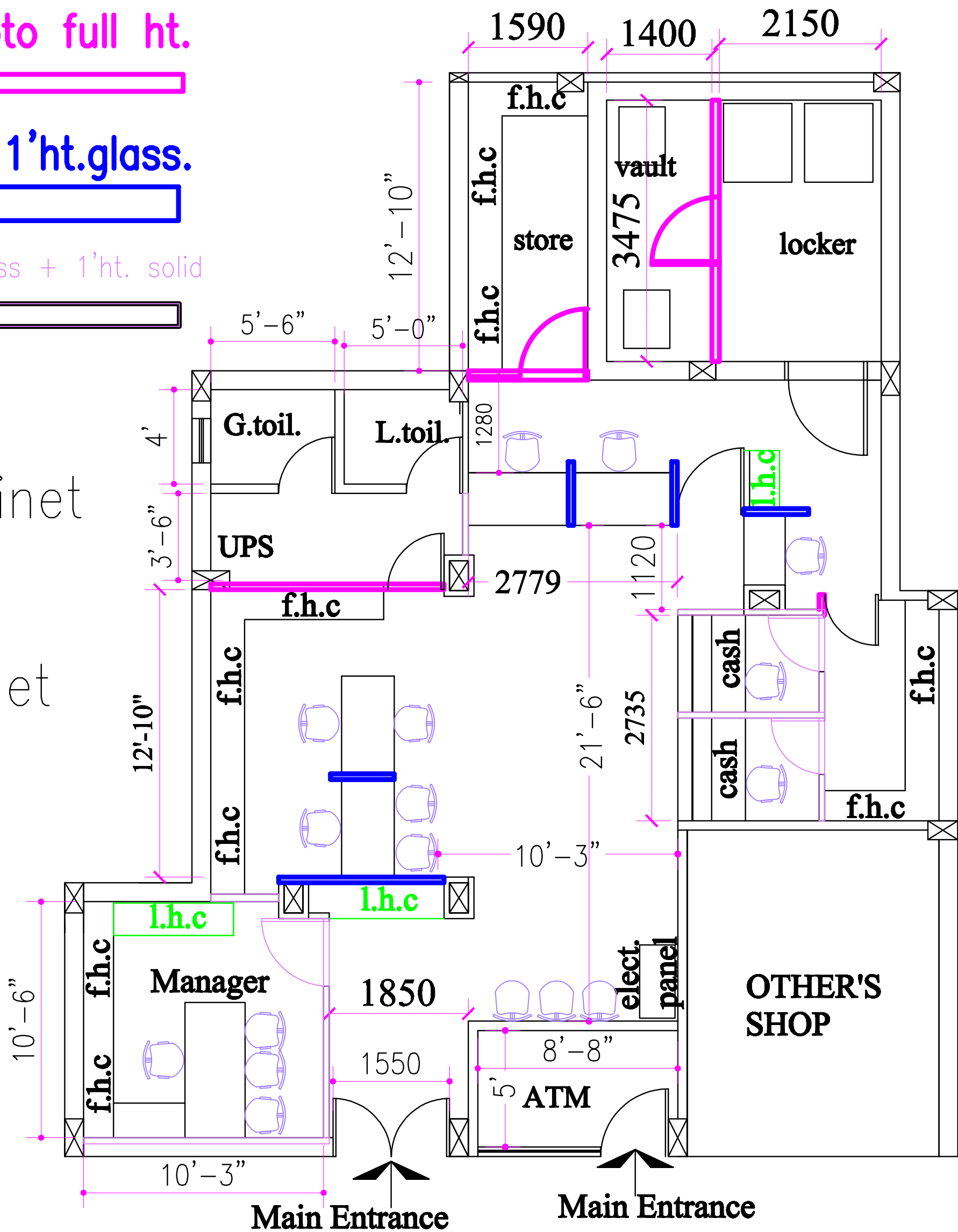
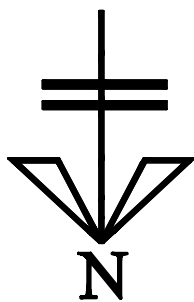

ARCHITECT:

**SANJOY PAUL AND ASSOCIATES**

AMANTRAN APARTMENT  
A-2 GROUP HSG. COMPLEX  
SECTOR -2A BIDHANNAGAR  
DURGAPUR-12

157/4/1A BAKULBAGAN ROAD  
KOLKIATA-700025  
MOB. NO. - 9333921690

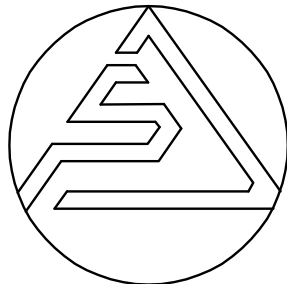

SCHEME - 2A  
REVISED  
dt. 10.08.2024